



**POLYURETHANE
ROUND BELT**

ARTICLE CODE

TUBOLAR BELT

TL 10 RB

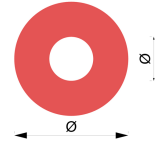

RAW MATERIAL TECHNICAL DATA

APPLICATIONS

ITEM DESCRIPTION	TUBOLAR BELT Ø 10 / 4
BASE RAW MATERIAL	THERMOPLASTIC POLYURETHANE
CO-EXTRUSION	/

THERMOWELDABLE BELTS FOR APPLICATION IN ANY KIND OF INDUSTRIAL TRANSPORT OR DRIVE SYSTEMS

BELT TECHNICAL DATA

PACKAGING

DATA	VALUE	U.M.	RANGE
SIZE	10 / 4	mm	+/- 0,2
HARDNESS	90	ShA	+/- 0,3
COLOR	Red Belt	--	--
FOOD COMPLIANT	No	FDA	--
WEIGHT	0,08	Kg./ml	--
REINFORCED	No	--	--
SURFACE FINISHING	Smooth	--	--
TEMP. MIN.	-20	C°	--
TEMP. MAX	+60	C°	--
PRETENSION	/	%	--
MIN PULLEY DIAMETER	/	mm	--
MAX WORK LOAD	/	Kg.	--
TENSILE FORCE AT 3% PRET.	/	Kg.	--

ROLL LENGHT	50	MT
ROLL WEIGHT	4	KG
PALLET	30/36	ROLLS

JOINING

TUBOLAR BELTS CAN BE PURCHASED AND USED BY METER OR MADE UP ENDLESSLY.
TUBOLAR BELTS CAN BE WELDED BY HOT AIR WITH BUTT WELDING

NOTE

N° IBTD 0184/21 Rev 0000

ISSUE DATE 01/03/21

Revision Date 0000